

Rep Name: \_\_\_\_\_

Email: \_\_\_\_\_

Phone Number: \_\_\_\_\_

Date: \_\_\_\_\_ / \_\_\_\_\_ / \_\_\_\_\_

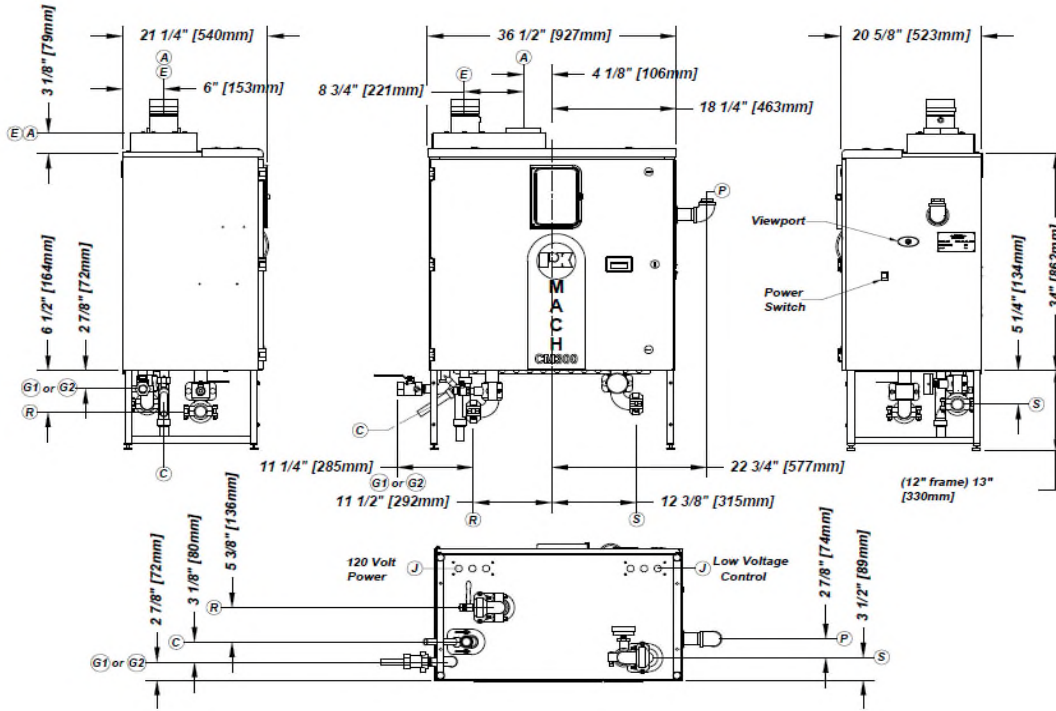

This MACH boiler requires Category IV venting (condensing-positive pressure) or Category II venting<sup>†</sup> (condensing -negative pressure) as defined in ANSI Z223.1/NFPA 54/CSA-B.149 latest edition.  
<sup>†</sup>Category II venting must include the optional combustion air damper

BOILER CONNECTIONS	
A	Combustion Air Inlet 5" dia. stub
C	Condensate Drain 3/4" hose
E	Exhaust Vent 4"
G1	Propane Gas 1" NPT-F
G2	Natural Gas 1" NPT-F
J	Wiring Junction Boxes inside cabinet
P	Pressure Relief Valve see list for options
R	Boiler Return, Victaulic® clamp 1 1/2" pipe, grooved
S	Boiler Supply, Victaulic clamp 1 1/2" pipe, grooved

MODEL SELECTION	
Boilers	<input type="checkbox"/> Natural Gas <input checked="" type="checkbox"/> <b>CM-300</b> <input type="checkbox"/> Liquid Propane
Fuel Options	<input type="checkbox"/> Natural Gas <input type="checkbox"/> Liquid Propane
Min Inlet Gas Pressure	3.5" w.c.
Max Inlet Gas Pressure	14" w.c.
Input (BTU/hr)	300,000
Output (BTU/hr)	279,000
Boiler HP	8.3
Operating Weight	290 lbs.
Shipping Weight	420 lbs.
Boiler Water Content	1.2 gallons
Shipping Dimensions	58"x38"x63" (LxWxH)
Power Supply	120V 1ph 60 Hz
Operating Current	< 5 Amps
Recommended Minimum Circuit Capacity	10 Amps

BOILER CONTROLS	
ASME CSD-1 is standard	
Complies with: GE GAP (IRI) guidelines GAP.4.1.0 and GAP.4.1.3	
FM Global 6-4 Section 1.0	
Main Gas Train with Dual Shut-off	
Integrated Boiler Control, NURO Series	
Operating Thermostat, 42°-195°F (5.6°-91°C)	
High Limit Thermostat, Manual Reset, 100°-197°F (38°-92°C)	
High Exhaust Back Pressure Switch	
LWCO, Probe Type, Manual Reset	
Combustion Air Proving Switch, Differential Pressure Type	
Combustion Blower, Variable Speed, 300 Watt	

PRESSURE RELIEF VALVE/PRESSURE-TEMPERATURE GAUGE	
Shipped Loose for Field Installation	
<input type="checkbox"/> 30 PSIG 3/4"x 1"	15-160 psi/0-250°F
<input type="checkbox"/> 50 PSIG 3/4"x 1"	15-160 psi/0-250°F
<input type="checkbox"/> 60 PSIG 3/4"x 1"	15-160 psi/0-250°F
<input type="checkbox"/> 75 PSIG 3/4"x 1"	15-160 psi/0-250°F
<input type="checkbox"/> 80 PSIG 3/4"x 1"	15-160 psi/0-250°F

A.S.M.E. SECTION IV DESIGN DATA	
Max Pressure	80 PSIG
Max Allowable Temperature	250°F
Max Setpoint	185°F
Heated Wet Surface Area	12.29 sq. ft.
Flow Rate @ 20°FΔT	28 GPM
Flow Rate @ 40°FΔT	14 GPM

RECOMMENDED CLEARANCE FOR SERVICE ACCESS				
Front - 36"	Rear - 0"	Top - 24"	Left Side - 2"	Right Side - 24"

Notes:  
- Victaulic is a registered trademark of Victaulic Company, Easton PA, USA  
- Patterson-Kelley reserves the right to make changes at any time without notification